

# Installation Manual

## LED Street Balance

### Application

LED Street Balance lighting fixture is suitable for:

- > street lighting
- > areal lighting



### Electrical characteristics

|                |            |
|----------------|------------|
| Supply voltage | 100-240VAC |
| Frequency      | 50/60 Hz   |
| Power factor   | >0.95      |

### Lighting characteristics

|                             |  |
|-----------------------------|--|
| Efficiency                  | up to 135 lm/W<br>up to 170 lm/W on request                                |
| Color rendering index (CRI) | >70, >80 on request  |
| Color temperature (CCT)     | 3000K/4000K/6500K  |
| LEDs                        | Philips LED SMD3030  |
| LED driver                  | Meanwell HLG-XLG/<br>Electrostart JSCo                                     |
| Beam angle lens options     | T2-65°x145° – 44°x155°<br>T3-70°x150° – 80°x150°<br>T4-85°x160° – 80°x160° |

### Protection

|                    |                      |
|--------------------|----------------------|
| Ingress protection | IP65/IP66 on request |
| Safety class       | Class I              |
| Surge protection   | L-N:4KV: L/N-GND:6KV |

Recommended usage Electrostart SPD 10/20kV for countries with lots of lightning/thundering

### Warranty conditions

|                       |                     |
|-----------------------|---------------------|
| Lifespan              | 50 000 h            |
|                       | 70 000 h on request |
| Warranty              | 5 Y/ 7 Y on request |
| Operating temperature | -20 ~ 40°C          |
| Storage temperature   | -20 ~ 60°C          |

### Body characteristics

|                        |                            |
|------------------------|----------------------------|
| Body material          | Die-casting aluminum alloy |
| Mounting hole diameter | 60 mm                      |
| Angle of movement      | 168°-192°                  |

### Standards

|                           |              |
|---------------------------|--------------|
| Harmonics                 | EN 61000-3-2 |
| EMC Immunity              | EN 61547     |
| Conducted Emission Test   | EN 55015     |
| Luminaires                | EN 60598-1   |
| LED Luminaire performance | EN 62722-2-1 |
| Photobiological safety    | EN 62471     |

| Product            | Rated Power | Luminous Flux | CCT               | Efficiency | Material of Body           | Length (mm) | Width (mm) | Height (mm) |
|--------------------|-------------|---------------|-------------------|------------|----------------------------|-------------|------------|-------------|
| LED Street Balance | 50W         | 6750          | 4000K/5000K/6500K | 135lm/W    | Die-casting aluminum alloy | 570         | 200        | 110         |
| LED Street Balance | 100W        | 13500         | 4000K/5000K/6500K | 135lm/W    | Die-casting aluminum alloy | 615         | 240        | 110         |
| LED Street Balance | 150W        | 20250         | 4000K/5000K/6500K | 135lm/W    | Die-casting aluminum alloy | 680         | 260        | 110         |
| LED Street Balance | 200W        | 27000         | 4000K/5000K/6500K | 135lm/W    | Die-casting aluminum alloy | 700         | 300        | 110         |
| LED Street Balance | 240W        | 32400         | 4000K/5000K/6500K | 135lm/W    | Die-casting aluminum alloy | 700         | 300        | 110         |
| LED Street Balance | 300W        | 40500         | 4000K/5000K/6500K | 135lm/W    | Die-casting aluminum alloy | 790         | 300        | 110         |

**LED'S START UP THE LIGHT**

**Headquarters**  
 Electrostart JSCo  
 Bulgaria, Sofia 1404, 81, Bulgaria blvd.  
 City General Business Center, building 2, floor 3, office 6  
 tel: +359 2 400 77 71, fax: +359 2 400 77 84

**Registered office and factory**  
 Electrostart JSCo  
 Bulgaria, Varshets 3540  
 2 Republika blvd  
 tel: +359 2 400 70 11, fax: +359 2 400 70 12

# DIMENSION

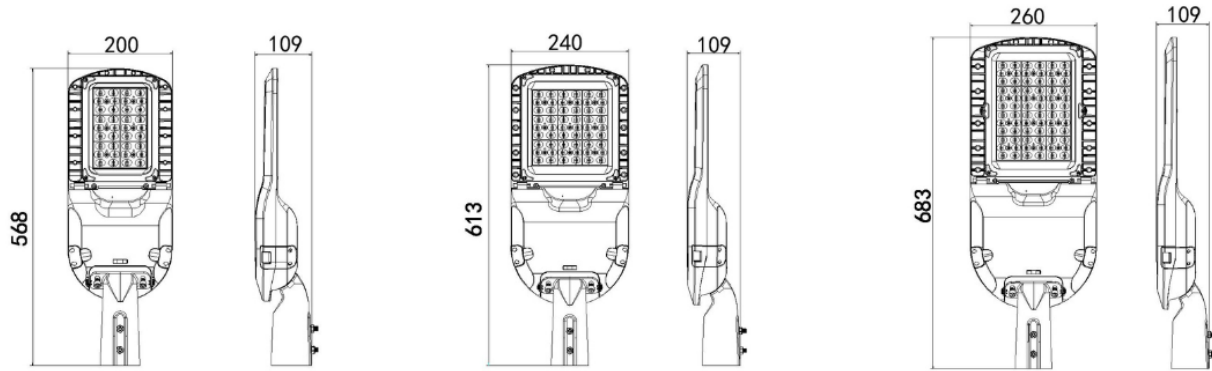

25-60W

80-120W

150-180W

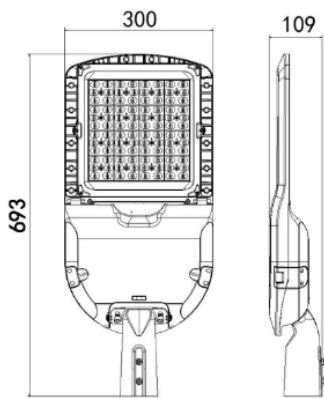

200-250W

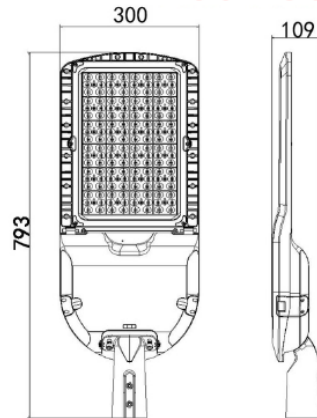

300-320W

Unit:mm

# INSTALL THE SHAFT

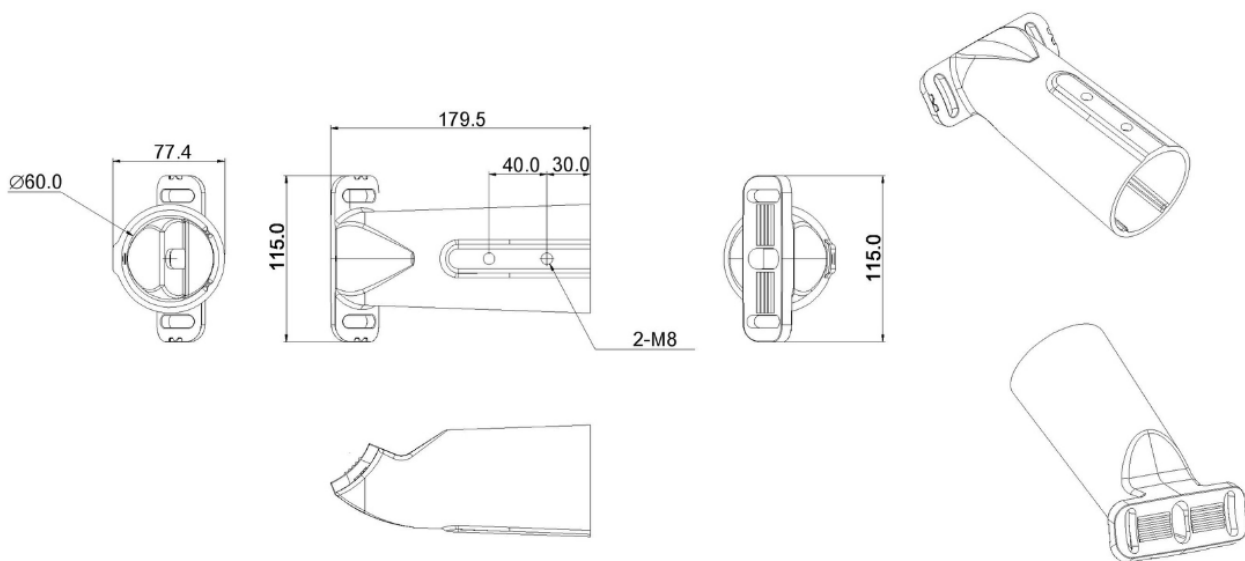

60 mm mounting holes

# PRODUCT INSTALLATION DRAWING

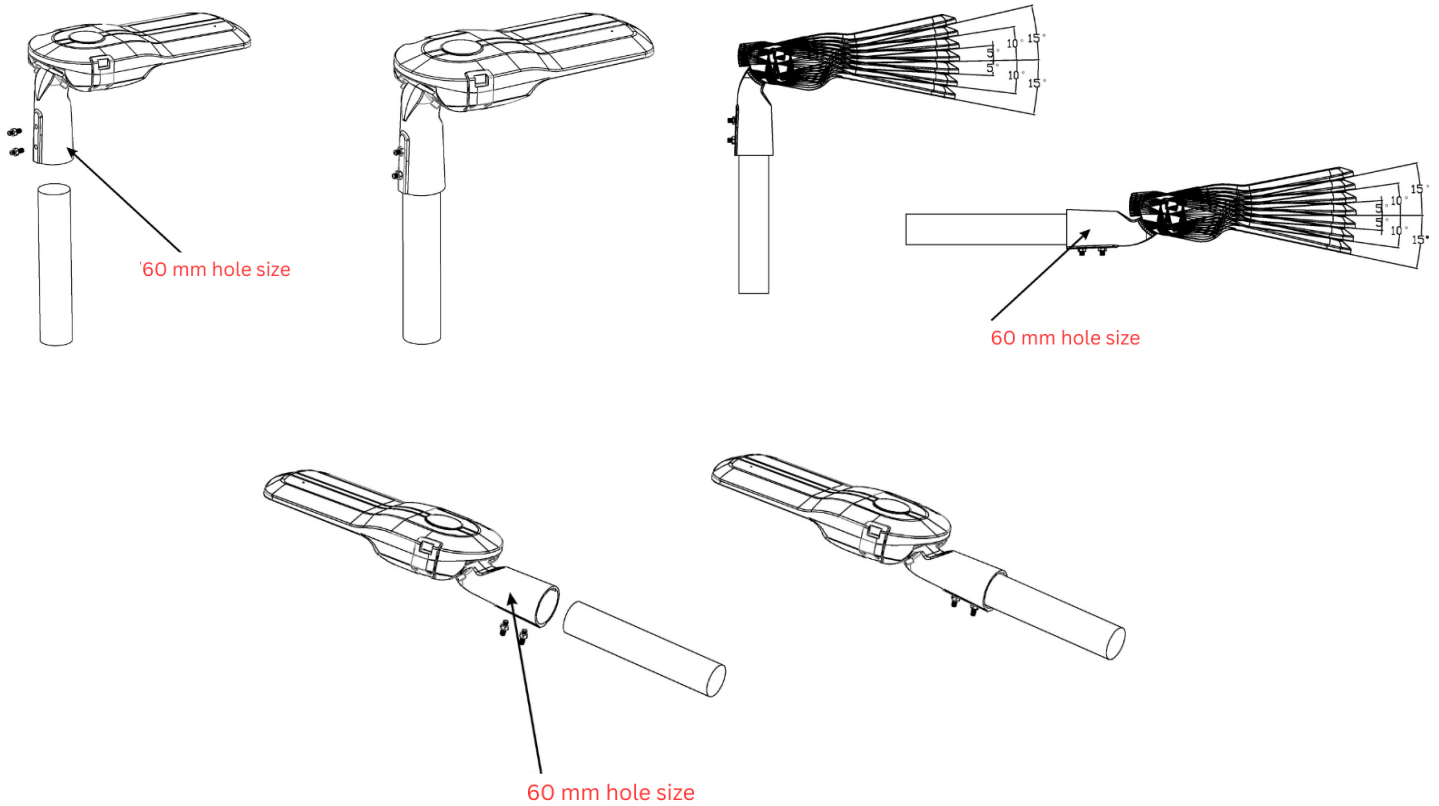

## ATTENTION

- Please do not disassemble the lamp without permission, or it will be deemed to have waived the warranty service.
- Please read the manual carefully before installation.
- Please check everything carefully before use. If any abnormalities occurred during use, please contact us immediately.
- Please make sure the power is turned off before installation.
- Please turn to professional electrician if any failure.

# PRODUCT MAINTENANCE

Quick disassembly replacement structure like followings



①



②

1. Use your hands to open the buckle, so that the main body of the radiator and the power cover are at a 90-degree angle



③



④

2. Open the safety rope spring buckle and take out the sling rope



⑤



⑥

3. Make the main body of the radiator and the power cover form an angle of 45 degrees, separate the main body of the radiator and the power cover post, take out the main body, replace without tools.

